



**ASTREA ACADEMY
SHEFFIELD**

Astrea Academy Trust
INSPIRING BEYOND MEASURE

Academy Prospectus



astreasheffield.org



Welcome to the Astrea Academy Sheffield. At Astrea, we are passionate about education that inspires beyond measure. The Astrea Academy Sheffield will be a beacon for the area – both literally and metaphorically: looking out over the city, it will provide an absolutely exceptional education.

Astrea was established in 2015. Our schools – primary, secondary and all-through – do not subscribe to the typical notion of “schooling” where everything is driven by results. Our pupils achieve to the very highest levels, but we believe that education is about so much more than just attainment.

To deliver this, we focus on encouraging and nurturing Resilience, Empathy, Aspiration, Contribution and Happiness in all of our children and young people. We also have the highest expectations of the staff in our family: responsibility

and leadership; aspiration and development; honesty and integrity; enjoyment and innovation; and collaboration and inclusion. These values are used as a measure of progress with individuals, schools and overall as a trust.

We believe in following a curriculum rich in knowledge and experience underpinned by rigorous assessment and opportunities to excel in sport, art and debating. We have the highest expectations of pupil behaviour, so that our teachers are able to focus on teaching to the ‘Astrea Teacher Standards’.

We are delighted to be opening Astrea Academy Sheffield in September 2018, welcoming 150 Year 7 pupils and 60 children into Reception. More detail on what life will be like at Astrea Academy Sheffield is set out in this prospectus. At Astrea, we are all dedicated to providing an education with no boundaries so that every pupil can fly, and I hope you will join us on this exciting journey.

Libby Nicholas
Chief Executive

Astrea Academy Sheffield – Our Mission

As young adults, pupils will leave Astrea Academy Sheffield with the necessary dispositions, character and academic qualifications to live a life full of opportunity and choice.

A broad and balanced curriculum based on knowledge, skills and experiences will enrich pupils' lives, build cultural capital and instil a love of learning. They will be able to apply their learning to real world contexts and problems, creating solutions in collaboration with others.

Pupils will learn to value family, community and the environment. They will make a positive contribution to the life of the school and those around them. Pupils will become resilient learners who are motivated to take responsibility for their learning, health, well-being and happiness.

Pupils will have high expectations of themselves, a culture of craftsmanship and a drive for excellence. They will understand the scope of possibilities that lie ahead of them and what is required to achieve their ambitions with the confidence and belief to make them a reality.

**Astrea Academy Trust – Inspiring
Beyond Measure**

A Unique Education

At Astrea Academy Sheffield, our curriculum is the purpose of our school. The curriculum is everything that we want our pupils to know and to understand. It includes learning about discrete subject disciplines such as the sciences, humanities and the arts and how these disciplines relate to one another. Our curriculum is also what we want pupils to achieve, the opportunities we offer them and the experiences we believe all pupils are entitled to.



English



Mathematics



Chemistry



Physics



Biology



Spanish



Geography



History



Physical education



Art



Business and Enterprise



Music



Drama



Computer Science



Design Technology



Religious Studies

KNOWLEDGE

SKILLS

EXPERIENCES

High Aspirations for All

At Astrea Academy Sheffield, we have the highest aspirations for our pupils and our teachers. With dedication, hard work and belief there is nothing that cannot be achieved. We set high expectations for the behaviour of all pupils and believe that excellent behaviour is the foundation of a successful school where pupils respect one another and fulfil their role within a learning community. This extends from the way pupils wear their uniform to the way they interact with peers and teachers. As pupils progress through the school, they take on additional responsibilities and from Key Stage 4 have the opportunity to fulfil leadership roles across the school. Our three school rules are simple. We expect all pupils to show Respect, Resilience and Responsibility.

Our school rewards system recognises and celebrates pupils who accept challenges and push themselves to do their very best – we have high expectations for every child. From a young age, children will learn about career opportunities and discuss their ambitions. All pupils need to understand what is available and appreciate that they are entitled to it all, no matter what their background. From a young age, pupils will learn about university, the opportunities higher education presents and when, rather than if, they go.





An Inclusive Education

At every stage from the age of 2, to the age of 18, we ensure an inclusive and fully supportive approach to ensure we meet the needs of all students, including those who are, or have been looked after, those with special educational needs and disabilities and those who are able and/or gifted. The early identification of vulnerable 2 year olds, and outreach work with families of 2-4 year olds in their homes prior to the start of school, are both essential areas of our approach and a reflection of our commitment to meeting the individual needs of every child.

We believe that every child and young person matters and all pupils have a common entitlement to a broad and balanced curriculum integrated in to all aspects of Academy life. We ensure that pupils of all abilities have the opportunity to flourish. We welcome students of all abilities and from all backgrounds; our teachers will take the time to get to know and understand every

individual. Whether they are doing very well, are struggling in an area of learning or need extra emotional or pastoral support, we will always work to meet their needs. It is crucial to identify a special educational need as early as possible and quickly implement strategies that support learning to promote achievement and attainment in all pupils.

At the first stage of a child's formal education or the point at which they join the school, we work effectively with all other agencies supporting children and their parents, to enable early identification of any holistic needs, including: paediatricians, GPs, physiotherapists, occupational therapists, sensory impairment specialists, speech and language therapists, educational psychologists, health visitors, children's centres, portage, social and welfare services and any specialist or support services. Early identification enables us to close any gap before it has the chance to grow, which is particularly important in the case of speech and

language development, which affect all other areas of learning.

Where pupils are underachieving and/or identified as having special educational needs, the school will provide for these additional needs in a variety of ways and will use a combination of these approaches to address targets identified for individual pupils.

The Astrea Academy Proposed School Day

Astrea Academy Sheffield operates an extended school day providing all pupils with a broad and balanced curriculum. We ask that all pupils arrive for breakfast with their teachers – a positive start to the day and an opportunity to ensure all pupils are fully prepared and ready to learn.

The school day offers three points of contact between pupils and their form tutor. Throughout the week this time is given to develop reading skills, study skills, knowledge retention and tailored subject support in small groups. A reflection session at the end of every day ensures all pupils review their learning, identify areas for development and celebrate their progress and achievements.

During period 6 all pupils will take part in the enrichment programme involving a range of sports, clubs,

Time	Activity
08:00–08:30	Breakfast
08:30–08:45	Registration / Assembly
08:45–09:45	Period 1
09:45–10:45	Period 2
10:45–11:00	Break
11:00–12:00	Period 3
12:00–12:45	Family Lunch
12:45–13:15	Tutor period – literature and theories of learning
13:15–14:15	Period 4
14:15–15:15*	Period 5
15:15–15:45	Reflections with tutors and preparation for following day
15:45–16:45	Period 6
* The school day ends at 15:15 on Friday	

competitions and additional qualifications. During this time, pupils will also take part in House competitions.

The Astrea Promise

Unique experiences are an important part of going to school. At Astrea Academy Sheffield we work hard to plan and create these opportunities for all our pupils. Not simply because they are exciting and valuable life experiences, but because they build the character and cultural capital that all pupils are entitled to. All pupils should have the opportunity to represent the school in competitions, perform on stage, visit the theatre, a foreign country and experience the best the arts, humanities and sciences have to offer. Whilst at the school all pupils will have the chance to:

- camp in a field or a forest
- visit a foreign country
- do an adventurous activity
- take part in the Astrea Olympics
- display artwork in a public space
- climb a mountain
- run an enterprise
- learn to play a musical instrument
- cook a meal for the family
- participate in a debate in an iconic building
- perform in an Astrea concert.



Astrea Academy Sheffield Campus

Astrea Academy Sheffield encompasses two contrasting facilities that bring together the traditions and history of education in Sheffield and the latest technology and facilities to provide pupils and the community with an outstanding environment for learning.

Overlooking Sheffield city centre, the new state of the art building will feature a full complement of highly equipped classrooms providing a bright and colourful learning environment for all pupils with additional open learning spaces for independent and small group study.

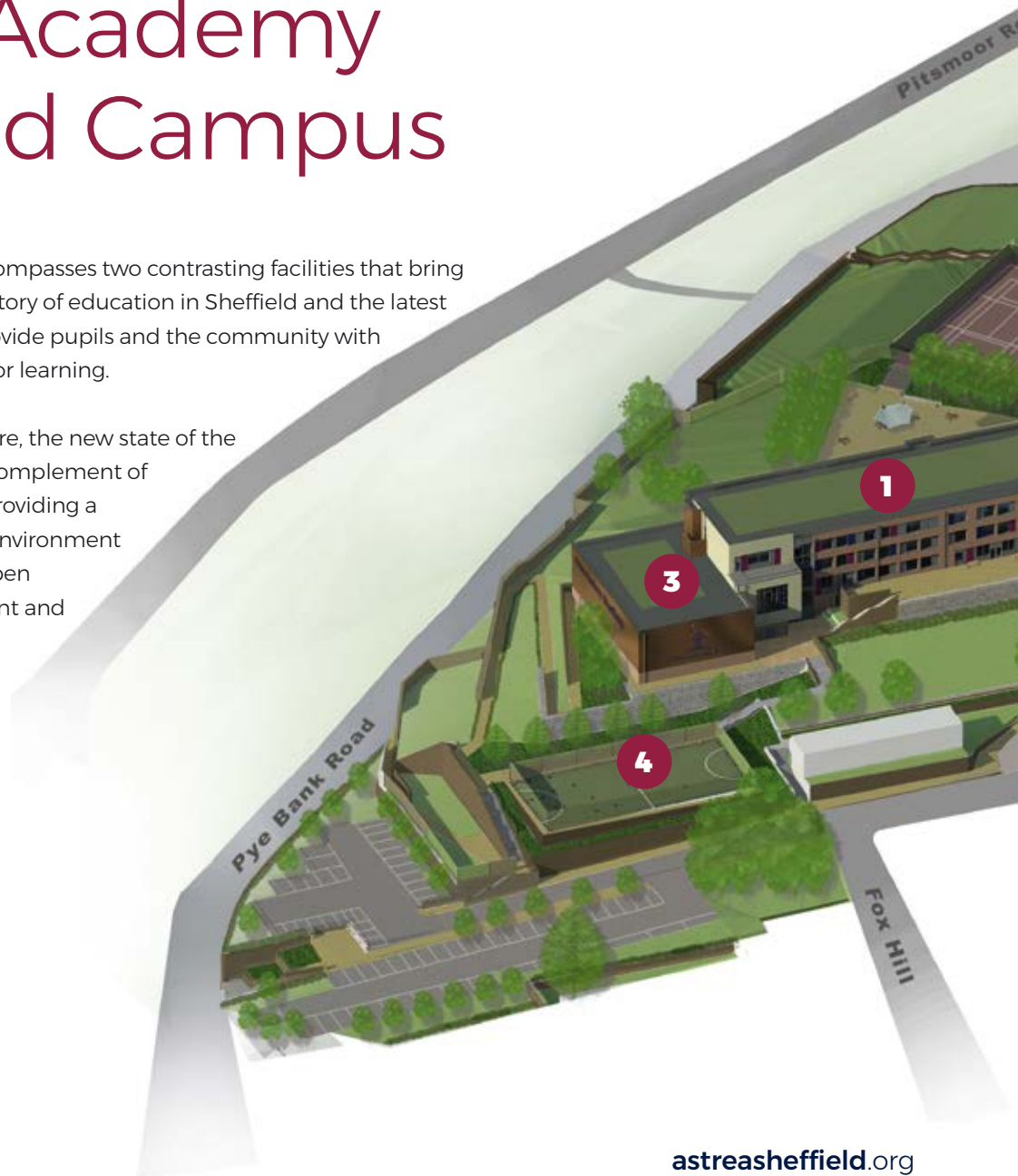

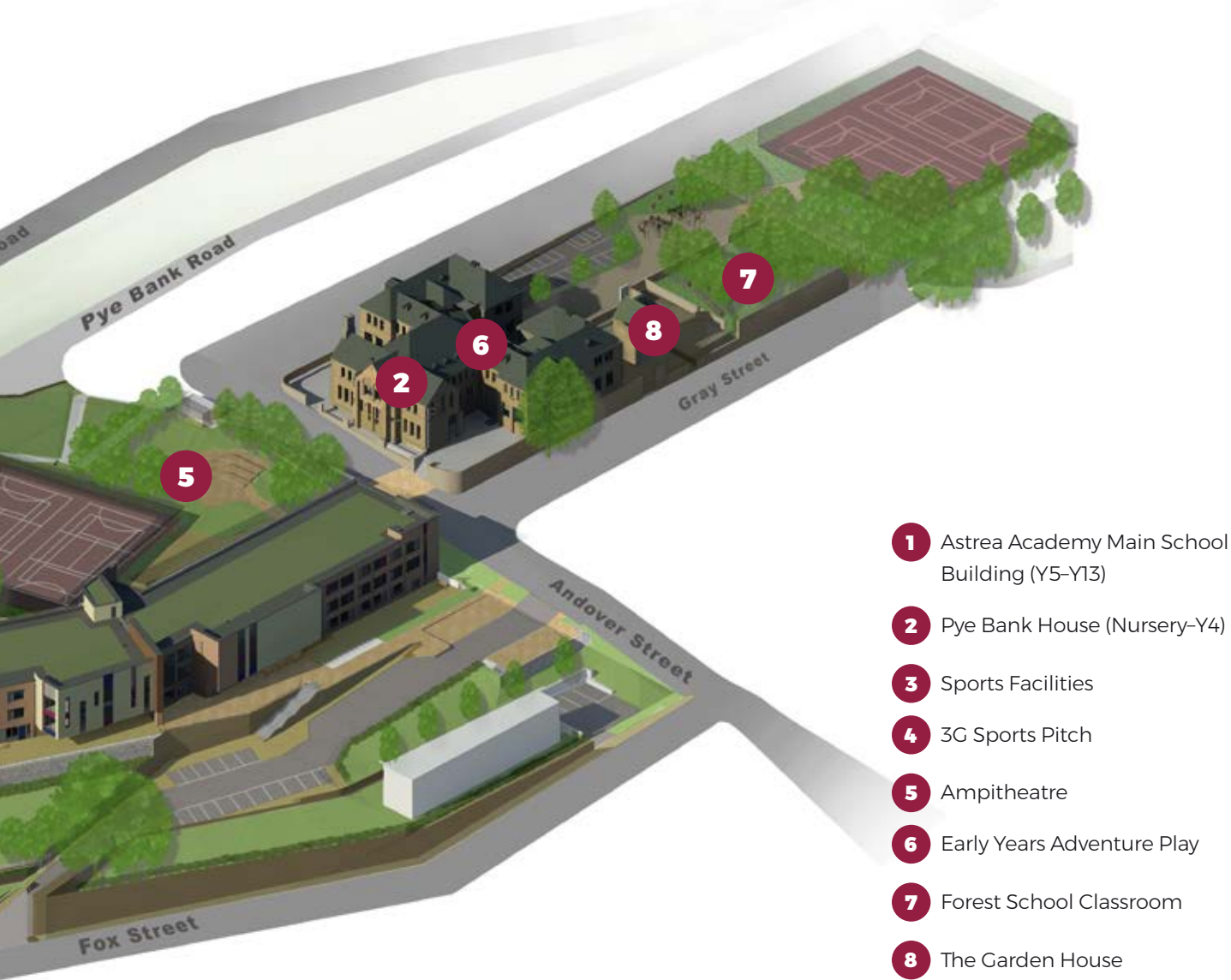

- 1** Astrea Academy Main School Building (Y5–Y13)
- 2** Pye Bank House (Nursery–Y4)
- 3** Sports Facilities
- 4** 3G Sports Pitch
- 5** Ampitheatre
- 6** Early Years Adventure Play
- 7** Forest School Classroom
- 8** The Garden House

Originally opened as the Pye Bank Board School in 1875. The beautiful grade II listed building is currently being restored to its former glory and developed into a modern primary school environment with the latest equipment and IT facilities. Pye Bank House will accommodate Nursery through to Year 4.

School Facilities

LOWER GROUND FLOOR PLAN

Three-court sports hall with excellent facilities for indoor sports including basketball, badminton, netball, football and gymnastics

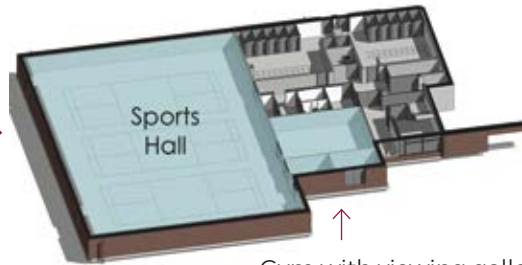

Gym with viewing gallery of the Sports Hall

GROUND FLOOR PLAN

Several large learning spaces including Main Hall, Drama Studio and Lecture Theatre for assemblies and whole-school performances and celebrations

State of the art classrooms in all subject areas

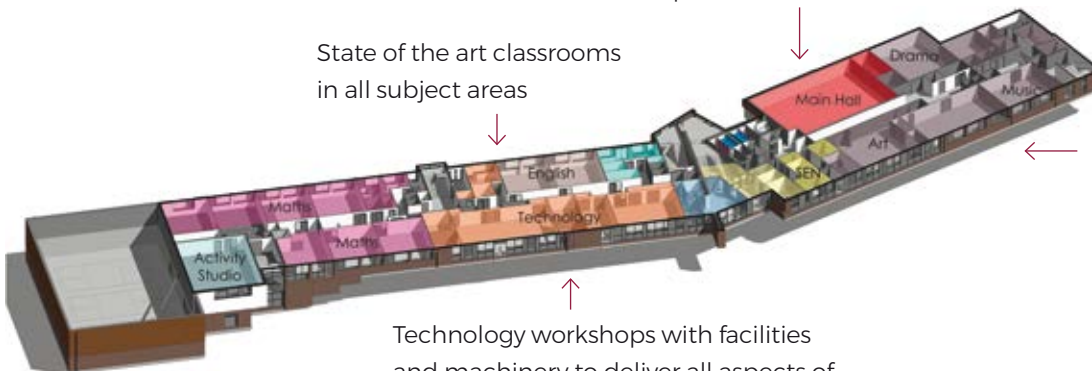

Dedicated Music and Art classrooms

Technology workshops with facilities and machinery to deliver all aspects of the design technology curriculum

UPPER GROUND FLOOR PLAN

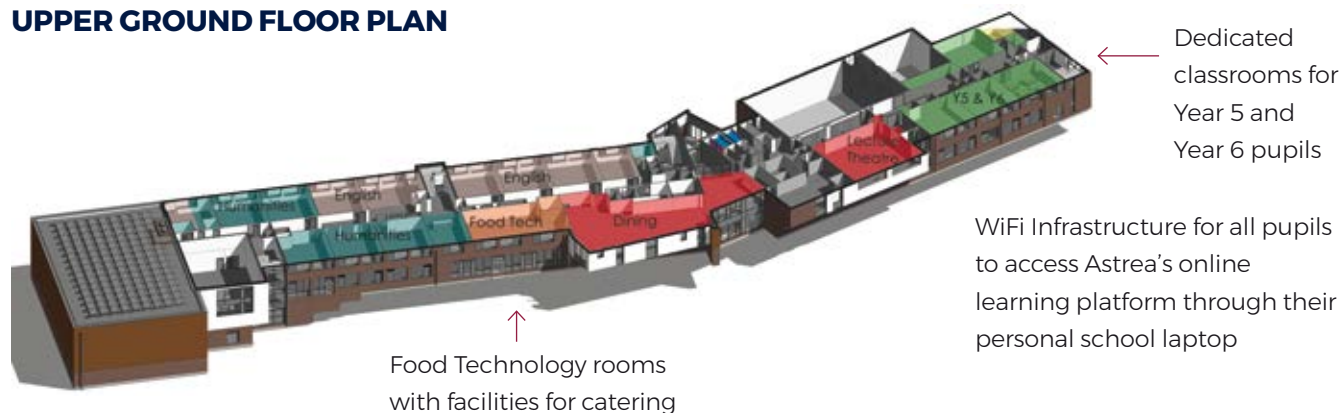

FIRST FLOOR PLAN

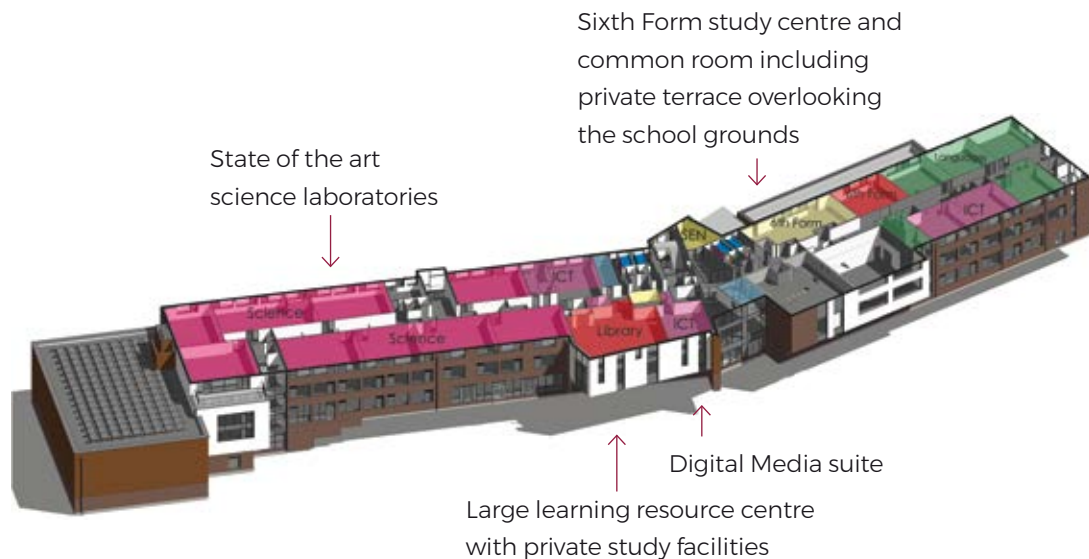

Industry and Community Partnerships

Our curriculum is designed to provide opportunities for pupils to work closely with local businesses and organisations. This will include opportunities for pupils to visit and work in the local area, complete projects linked to a variety of industries and gain industry specific qualifications along the way leading to training and employment. Each

term pupils will take part in a 'Big Problem' themed day. These days engage pupils in some of the problems and issues facing society and allow them to apply the knowledge and skills they have developed across the term, managing an extended task in a real-world context. Our partnerships with the local community will be a

focus of these days and create further opportunities to deliver the school's careers education programme and the Astrea Promise.

The Enrichment Programme

Everyday offers opportunities for pupils to engage in enrichment activities developing skills, interests and knowledge in a wide range of areas. This includes a range of sports, clubs, debating, creative arts,

enterprise projects, additional languages and personal projects linked to the Astrea Baccalaureate.



Astrea Baccalaureate

The Astrea Baccalaureate is a personal project that pupils will have the opportunity to complete at Bronze, Silver and Gold levels during their time at the school. The Astrea Baccalaureate ensures that all pupils not only succeed academically, but through opportunities linked to their interests and personal development.

The Astrea Baccalaureate provides a platform to celebrate the achievements of all pupils in a wide range of academic, creative and personal endeavours.

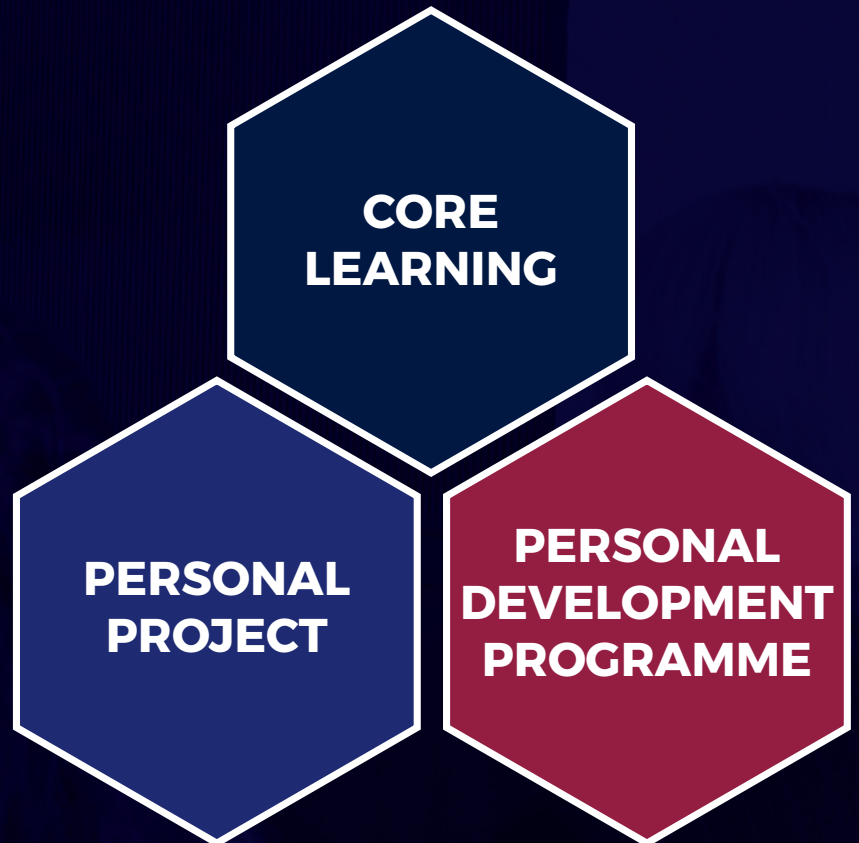

Astrea Academy Sheffield Sixth Form

Astrea Academy Sixth Form will provide an aspirational choice for students in the north of the city and a natural progression for Astrea Academy pupils into further education. With a team of expert teachers that know our students and their aspirations, the Astrea Academy Sixth Form will provide a bridge to university with exceptional careers and higher education advice and support. The Sixth Form will provide students with new freedoms and new responsibilities, as well as the opportunity to take a leading role in the school. Including supporting younger pupils with reading, holding positions as House Captains, Subject Leaders, Sports Leaders or setting up and running their own clubs and school events – our Sixth Formers act as role models for pupils across the academy.

Our Sixth Form curriculum will place a premium on independent study, discussion and the development of ideas. All students will study 3 A levels subjects or similar qualifications including Level 3 BTEC and engage in a personal development programme covering leadership, wellbeing, cultural, creative and community initiatives.

With excellent teachers and a supportive learning environment, including a dedicated Sixth Form lounge, careers library and private study facilities, the Sixth Form is the culmination of an exceptional all-through education.





How to apply for a place at Astrea Academy Sheffield

When choosing Astrea Academy Sheffield we highly recommend placing it as your first choice in order to have your best chance of obtaining a place. The indicated admissions number of Astrea Academy Sheffield is 150 places for Year 7 in 2018.

Astrea Academy Sheffield is part of Sheffield County Council's admissions scheme. To apply for a place in September 2018, parents must select Astrea Academy Sheffield as a preference on the online admissions portal or a hard copy application form, enclosed with this brochure.

Some families were unaware that Astrea Academy Sheffield was a secondary option for their child. Any families wanting to choose Astrea Academy Sheffield, that have already submitted admissions forms are able to amend their choices by contacting Sheffield Admissions and submitting

a new application in one of the following ways:

1. If you have already applied online, login to the admissions portal with your username and password. Click 'amend' and update your preferences.
2. If you have sent a hard copy you can:
 - email ed-admissions@sheffield.gov.uk with your child's name, date of birth, address, current school and your amended preferences by 31st October.
 - Or, write to pupil admissions stating that you would like to amend your preferences.

PUPIL ADMISSIONS

Floor 5
North Wing
Moorfoot
S1 4PL

The closing dates for online applications is the 31st of October 2017 for secondary school places.

Please visit our website to view our admissions arrangements and catchment area maps. You will also find a link to the admissions portal on the Sheffield City Council website.

www.astreasheffield.org





astreasheffield.org